

10301 Grand Central Ave,  
Owings Mills, MD 21117

BUILDING  
SPECS



**METRO  
CENTRE**

**KEN BERNSTEIN**

Senior Vice President  
of Retail Leasing  
410.581.2437

[kbernstein@davidbrown.com](mailto:kbernstein@davidbrown.com)



10301 Grand Central Ave,  
Owings Mills, MD 21117

SITE  
PLAN

**1,606 SF to 3,884 SF Available**

Revised December 2021

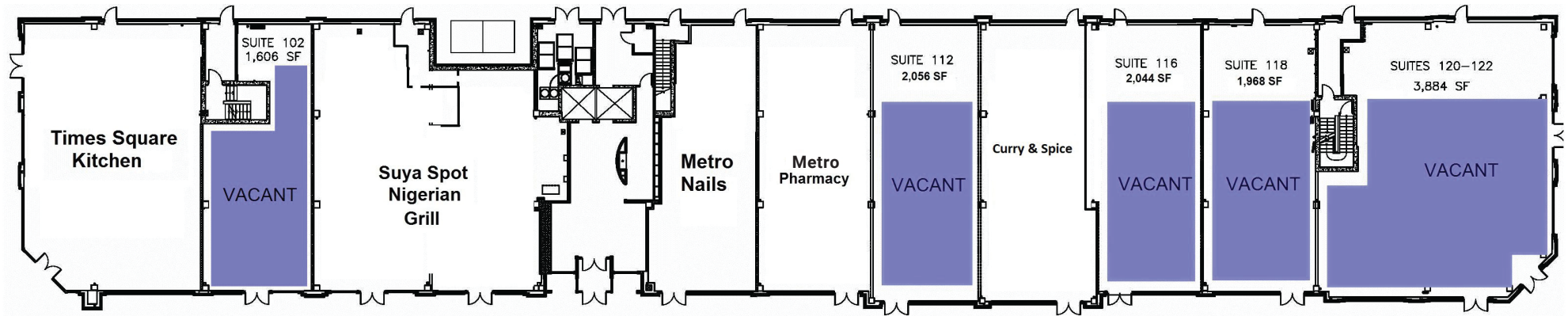

**METRO  
CENTRE**

**KEN BERNSTEIN**

Senior Vice President

of Retail Leasing

410.581.2437

kbernstein@davidsbrown.com

